



## **PACIFIC ENERGY GAS REMOTE TOGGLE THERMOSTAT MODE**

1. Remove the middle battery



2. Press and **hold** the thermostat button

*(your remote will be off – picture illuminated for illustration purposes)*



3. Whilst depressing the thermostat button, reinsert the middle battery
4. Release the thermostat button
5. This will toggle the thermostat mode on / off



**CANADA'S FINEST STOVES**

## **PACIFIC ENERGY GAS REMOTE SET OR CLEAR DIFFERENT MODES**

1. Remove the middle battery



2. Press and hold the **power** button and the **mode** button

*(your remote will be off – picture illuminated for illustration purposes)*

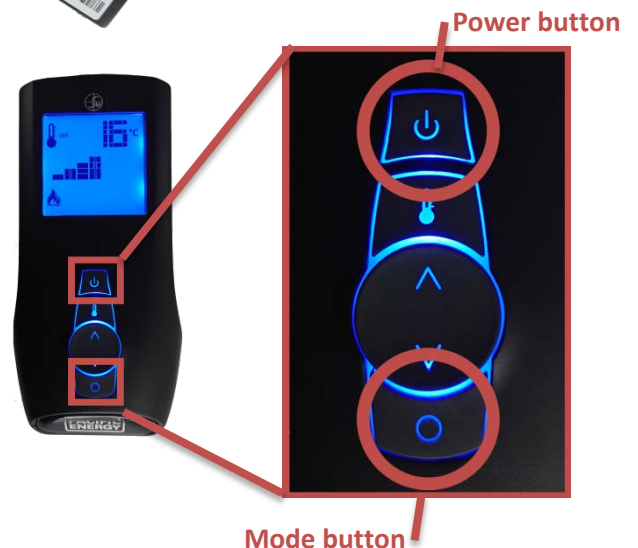

3. Reinsert the middle battery
4. While still holding the power button, release the **mode** button



1. Press the **mode** button to toggle between modes  
*Each mode will show either SET (visible) or CLR (not visible)*
2. Press the **up** or **down** arrow button to toggle between SET or CLR
3. When finished release the on /off button